



BÂTIMENT NORD REZ-DE-CHAUSSÉE

-  **Surfaces commerciales**
980.20 m²
-  **Terrasses**
-  **Locaux techniques**

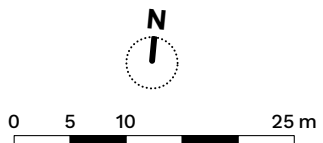
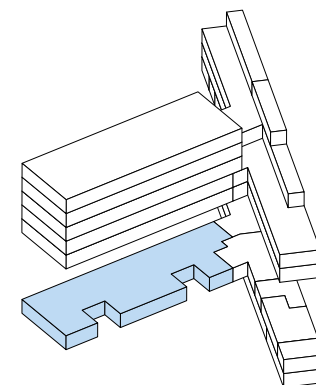
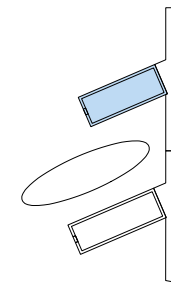

Les terrasses peuvent être louées avec les surfaces commerciales.

Les surfaces utiles effectives peuvent varier par rapport aux indications des plans. Sous réserve de modifications.