



BÂTIMENT CENTRAL

REZ-DE-CHAUSSÉE PROMENADE

-  **Surfaces commerciales**
1'984.10 m²
-  **Terrasses**
-  **Locaux techniques**

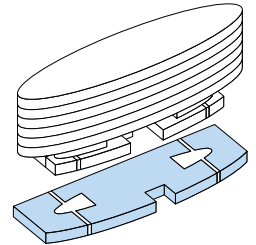
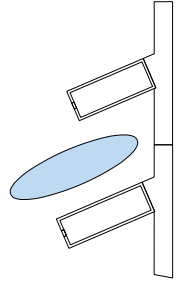
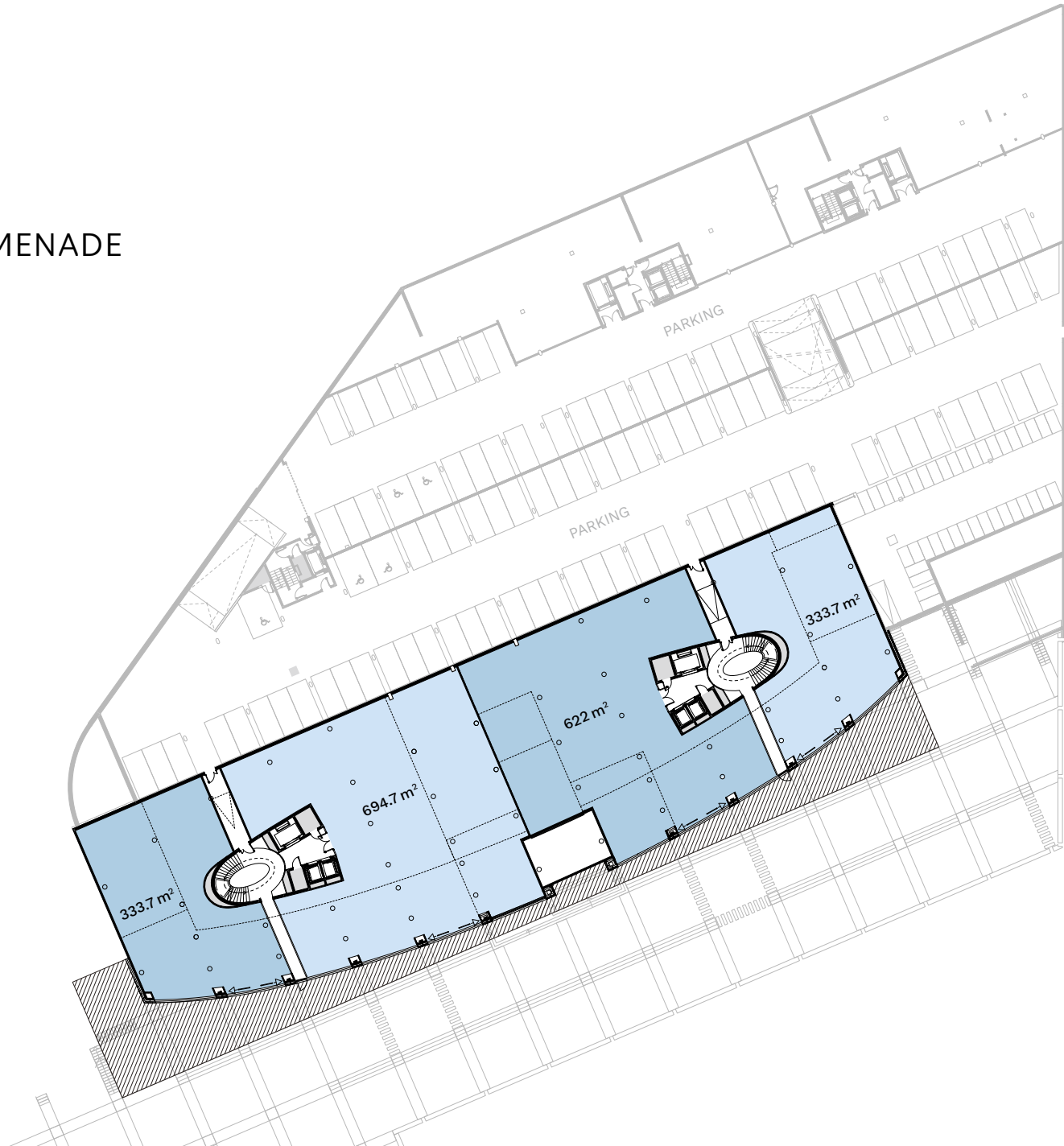

0 5 10 25 m

Les terrasses peuvent être louées avec les surfaces commerciales.

Les surfaces utiles effectives peuvent varier par rapport aux indications des plans. Sous réserve de modifications.